

Model

Applicable To

File Under

Bulletin No.

1996-98
CIVIC

ALL



99-034

Issue Date
JUNE 1999

Safety Recall: Civic Floor Mat

(Supersedes 99-034, dated May 1999)

BACKGROUND

Due to the shape of the floor, a mispositioned floor mat could prevent the accelerator pedal from returning to the idle position. In this case, the vehicle may continue accelerating even though the driver may no longer be pressing on the pedal.

CORRECTIVE ACTION

Anchor the driver's floor mat with a holder and grommet.

PARTS INFORMATION

Floor Mat Retention Kit (10 per package):
P/N 08P15-S01-100W

Grommet (10 per package): P/N 08P15-S01-100G

REQUIRED SPECIAL TOOLS

Grommet Installation Tool Set:

These tool sets are being automatically shipped to the distributors.

WARRANTY CLAIM INFORMATION

Flat rate time: 0.2 hour
Failed part: P/N 08P15-S01-16002
Defect code: 337

IDENTIFICATION PROCEDURE

Examine the driver's side floor mat to make sure it is a Genuine Honda accessory.

- If it is not a Genuine Honda accessory floor mat, return the car to the customer.
- If it is a Genuine Honda accessory floor mat, continue to REPAIR PROCEDURE.

UNDERSIDE OF DRIVER'S SIDE FLOOR MAT

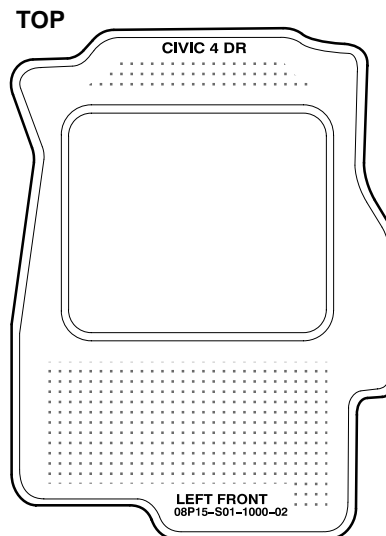

Marking at Top	Marking at Bottom
2D	08P15-S02-1xx
3D	08P15-S00-1xx
4D	08P15-S01-1xx

xx = any combination of letters/numbers

REPAIR PROCEDURE

1. Move the driver's seat all the way back. Remove the floor mat from the car.
2. Locate the two slits in the carpet under the front of the driver's seat.

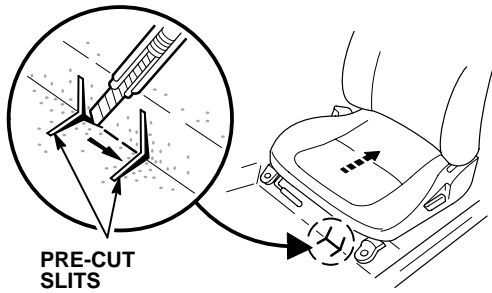

3. Cut the carpeting between the slits. Fold back the two flaps.
4. Insert the plastic nut into the square hole in the floor.

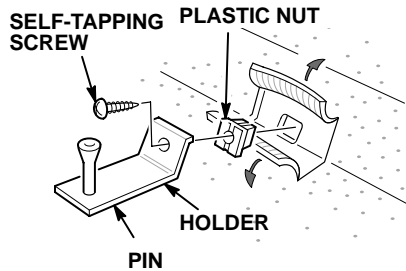

5. Install the floor mat holder with the self-tapping screw.
6. Measure the floor mat dimensions A and B according to the chart. Mark that point on the mat with a magic marker.

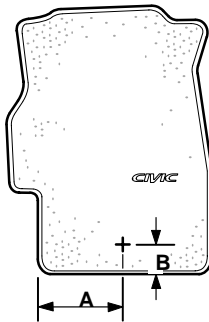

	Dimension A	Dimension B
2-door & 4-door	110 mm	35 mm
3-door	135 mm	35 mm

7. Place the floor mat on a block of wood. Punch a hole in the floor mat at the marked point with the special tool.

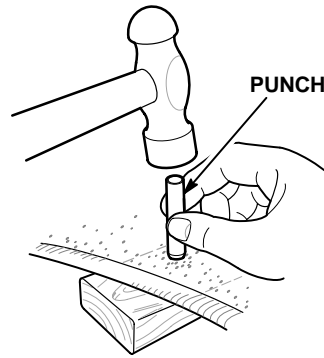

8. Use a small knife to remove the rubber nubs on the back side of the mat around the hole.
9. Push the grommet into the hole from the carpeted side.
10. Place the lock ring around the base of the grommet.

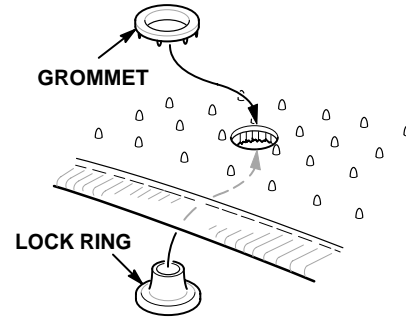

11. Use the special tools and a hammer to flare the lock ring.

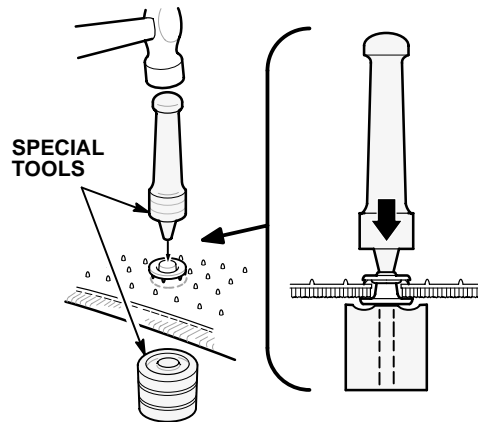

12. Reinstall the floor mat in the car.
13. Center-punch a completion mark over the fourth character (E) of the engine compartment VIN.



June 1999

Important Safety Recall Notice

Dear Civic Owner:

This notice is sent to you in accordance with the requirements of the National Traffic and Motor Vehicle Safety Act.

What is the reason for this notice?

Honda Motor Co., Ltd. has determined that a defect relating to motor vehicle safety exists with the Genuine Honda Accessory driver-side floor mat for certain 1996–1998 Civics automobiles. Due to the floor design in these vehicles, a mispositioned floor mat could prevent the accelerator pedal's return to the idle position. In this case, the vehicle may continue accelerating even though the driver may no longer be pressing on the pedal. Continued acceleration, when the driver is expecting the vehicle to slow, could result in an accident.

What should you do?

As soon as possible, you should determine if your car is equipped with a Genuine Honda Accessory floor mat in the driver's position. Honda floor mats are shaped like the illustration below. If yours looks like the illustration, you probably have an affected mat.

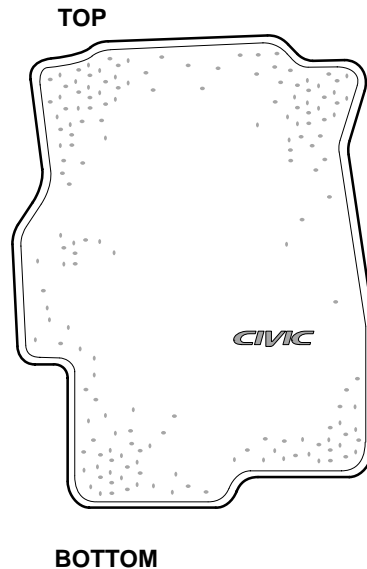

If You Have a Honda Floor Mat

Call any authorized Honda automobile dealer/distributor and make an appointment to have your vehicle repaired. They will install a positive floor mat retention system that will help keep the mat in the correct position. *This repair will be done free of charge.* Parts are now available. Although this repair takes less than an hour, please plan to leave your car for half a day to allow the dealer/distributor flexibility in scheduling.

In the meantime, make sure your mat is positioned properly. If the floor mat moves easily, and you're concerned about it interfering with the accelerator pedal, remove the mat and store it in the trunk until your repair appointment with the dealer/distributor.

If You Have a Non-Honda Floor Mat

If your driver's side floor mat does not look like the illustration, it is not a Genuine Honda Accessory mat. Honda has not evaluated aftermarket floor mats, and we do not know if aftermarket mats will interfere with the accelerator pedal.

We recommend that you check your mat to be sure it does not interfere with the accelerator pedal. If you are concerned, we recommend that you remove the floor mat. If you have more than one floor mat on the driver's side floor, we suggest that you remove any additional mats until only one mat remains.

Please let us know that your car is not affected by contacting your dealer/distributor.

Who to contact if you experience problems.

If you are not satisfied with the service you receive from your Honda dealer/distributor, you may write to:

(Distributor – enter name, address and telephone number)

What to do if you feel this notice is in error.

This notice was mailed to you according to the most current information we have available. If you no longer own this vehicle, or some information in this notice is incorrect, please contact your dealer/distributor. This will help us to update our records.

If you have questions.

If you have questions about this notice, please call:

(Distributor – enter name and telephone number)

We apologize for any inconvenience this may cause you.

Sincerely,

(Distributor name)