

1997-99 CR-V: PDI and New Model Information

(Supersedes 97-006, dated June 1998)

Some systems and components on the 1997-99 CR-V look and operate the same as those on other Honda vehicles, but some do not. This bulletin describes differences in these systems or components, and offers some new model information:

- Fuses
- Front License Plate Holder
- Shift Lock Release Cover
- Tie-Down Hole Plugs
- Tie-Down Warning Labels
- Towing the CR-V Behind a Motorhome
- Towing With the CR-V
- Dyno Testing
- On-Car Wheel Balancer and On-Car Brake Lathe
- Service Connectors
- Optional Keyless Entry System and Security System
- Rear Differential Maintenance
- Accessory Power Sockets
- Spare Tire Cover Spacer
- Tailgate Operation
- Air Conditioning Filter
- Immobilizer System

FUSES

To prevent battery drain, two fuses are not installed in the under-hood fuse/relay box at the factory:

- INTERIOR LIGHT (7,5 A)
- BACKUP (RADIO) (7,5 A)

Remove these two fuses from the ashtray, and install them in the under-hood fuse/relay box.

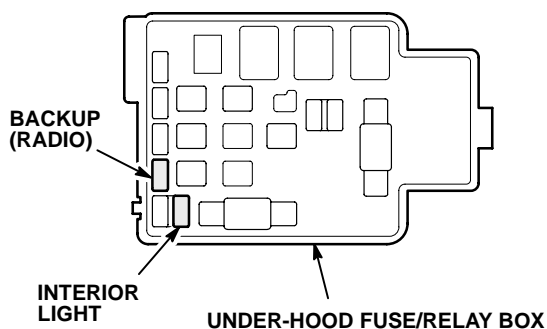

FRONT LICENSE PLATE HOLDER

Install the front license plate frame and lower bracket.

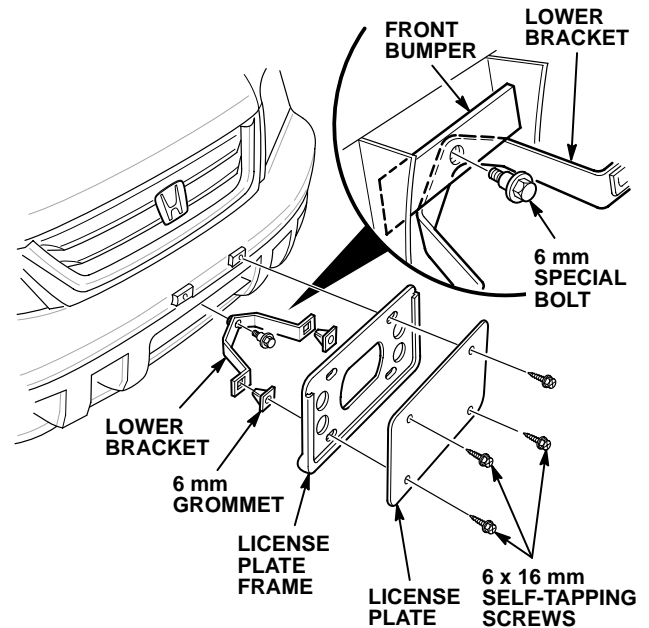

SHIFT LOCK RELEASE COVER

The shift lock release is on top of the steering column. The cover is stored in the glove box during shipping so the shift lock release can be used during shipment. Install the shift lock release cover during PDI.

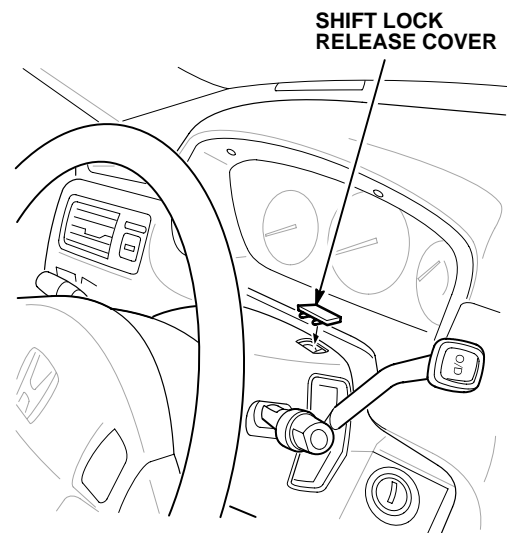

TIE-DOWN HOLE PLUGS

The tie-down points used during transportation to the dealer are exposed to splash from the tires. Grommets are provided in the PDI plastic bag to plug the holes and prevent debris from entering. Install all four plugs during PDI.

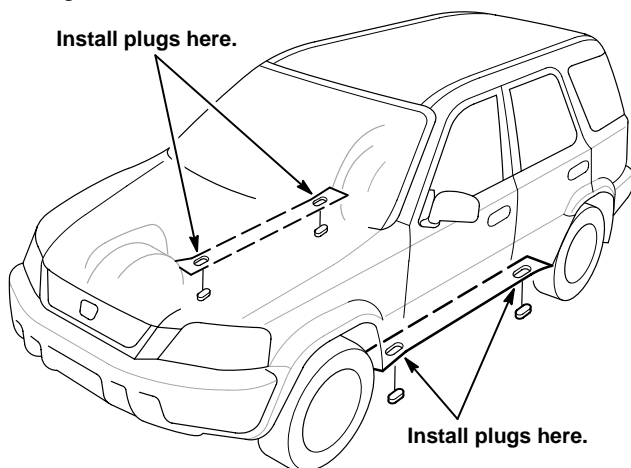

TIE-DOWN WARNING LABELS

Remove the warning labels attached to the front tie-down plates. This warning label refers to safe vehicle transportation. These tie-down plates can be used when transporting the CR-V on a flatbed tow truck.

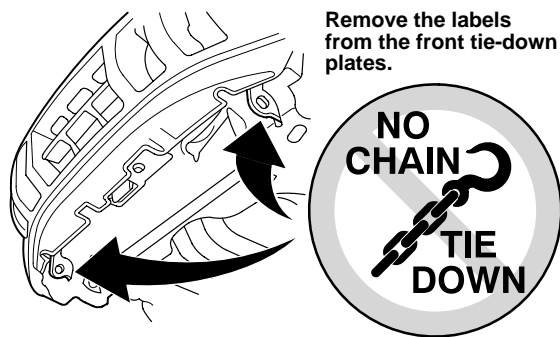

TOWING THE CR-V BEHIND A MOTORHOME

The CR-V may be towed with all four wheels on the ground at highway speeds (up to legal speed limit for towing) behind a motorhome or other vehicle.

Since the CR-V's 4-Wheel Drive system engages automatically, the CR-V must be towed with all four wheels on the ground. Do not tow the CR-V with only two wheels on the ground, this will damage the 4WD system.

As with all Honda vehicles that have automatic transmissions, you must take certain precautions to avoid transmission damage when towing with all four wheels on the ground.

NOTICE

If you do not follow this procedure, you will damage the transmission.

1. Check to be sure the transmission fluid level is full.
2. Start the engine.
3. Shift the transmission from Park to Drive.
4. Shift from Drive to Neutral.
5. Turn off the engine, leave the key in the ACCESSORY (I) position.

NOTICE

Never tow the CR-V with the steering wheel locked. Always leave the key in the ACCESSORY (I) position to prevent damage to the steering system when towing behind another vehicle.

If the engine cannot be started for some reason, the CR-V must be transported on a flatbed tow truck.

American Honda does not endorse or recommend any specific manufacturer of tow bars for the CR-V. Make sure that you choose a reputable company when selecting a towing device, and follow the manufacturer's instructions.

TOWING WITH THE CR-V (KG, KE, KS models only)

The maximum tongue weight of any trailer should be 50 kg, and the maximum weight that can be towed by the CR-V depends on the transmission type and the type of trailer:

- Trailers without brakes – 600 kg
- A/T vehicles towing trailers with brakes – 1.200 kg
- M/T vehicles towing trailers with brakes – 1.500 kg

DYNO TESTING – 4-Wheel Drive Models

Because the 4-Wheel Drive system engages automatically, you must place all four wheels on rollers when running the vehicle on a dynamometer, such as during emissions testing or speedometer testing. Follow the equipment manufacturer's instructions for proper use.

ON-CAR WHEEL BALANCER AND ON-CAR BRAKE LATHE – 4-Wheel Drive Models

On-Car Wheel Balancer: Because of the automatic engagement of the 4-Wheel Drive system, you must have all four wheels off the ground when using an on-car wheel balancer. All four wheels must rotate freely.

On-Car Brake Lathe: Due to the automatic engagement of the 4-Wheel Drive system, you must have all four wheels off the ground when using a brake lathe. You also must block the front wheel opposite the one you are cutting. If the opposite wheel is not blocked, the rotor you are cutting will stop rotating.

SERVICE CONNECTORS

The CR-V's service connectors are located in these areas:

- SCS – Under the center of the dashboard on the passenger's side (blue 2P connector).

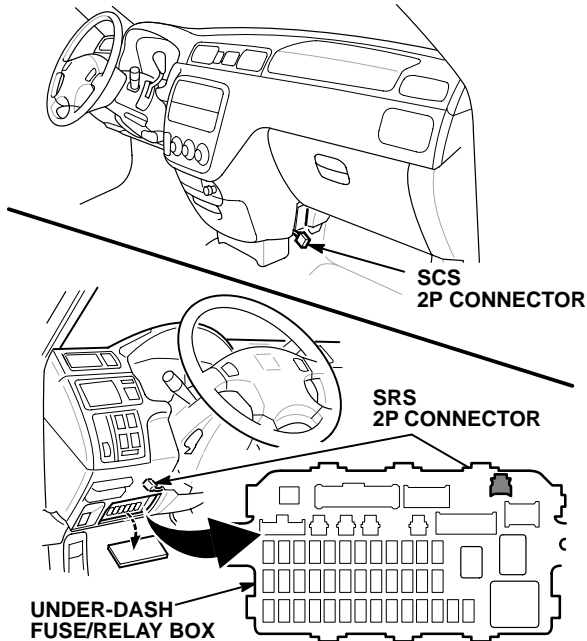

- SRS – Plugged into the under-dash fuse/relay box (yellow 2P connector).

OPTIONAL KEYLESS ENTRY SYSTEM AND SECURITY SYSTEM

The CR-V has both a Keyless Entry System and a Security System (with keyless entry; KK model only) available as optional equipment. The two systems are different from each other, and they are not interchangeable or compatible with one another. When working on the CR-V, be sure you know which system you're working with. The keyless remotes look very similar but they are not interchangeable. A way to tell if the vehicle has a Genuine Honda Security system is to look for the LED mounted on the top of the steering column cover.

Keyless Entry System (KK, KE, KG, KM)

The keyless entry system is similar to the Civic system but it is not exactly the same. On the CR-V, the main circuitry is factory-installed in the driver's door. With this system, like the Civic keyless system, there is nothing

to install; just program the remotes. This system can store the codes of up to three remotes.



Keyless Remote
(KK model only)

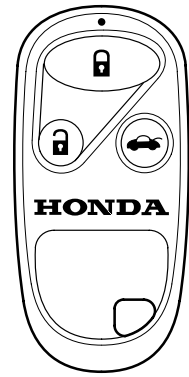

Keyless Remote
(KE, KG, and KM)

Security System (KK model only)

The security system has the same features as the Accord and Prelude systems, with the addition of a hatch glass release. The hatch glass can be opened by pressing the OPTION button on the remote and holding it for two seconds. The hatch glass can be opened to load cargo even if the security system has not been disarmed. After the hatch glass is closed, the vehicle is again protected.

The security kit comes with two remotes that are preprogrammed to the control unit. Two additional remotes can be added to the system, giving the customer a total of four remotes.

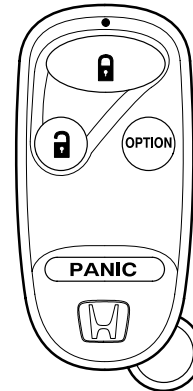

Security Remote
(KK model only)

REAR DIFFERENTIAL MAINTENANCE

The dual-pump system in the rear differential uses Genuine Honda CVT fluid. Refer to the Owner's Manual for the correct oil change schedule.

ACCESSORY POWER SOCKETS

Two accessory power sockets are standard on the CR-V. One socket is located in the dashboard by the ashtray and the other socket is in the rear cargo area below the left rear speaker. Each socket can operate a 12-volt accessory that is rated up to 120 watts or less (10 amps). The sockets are only usable when the ignition switch is in the ACCESSORY (I) or the ON (II) positions. The sockets will not power an automotive cigarette lighter element.

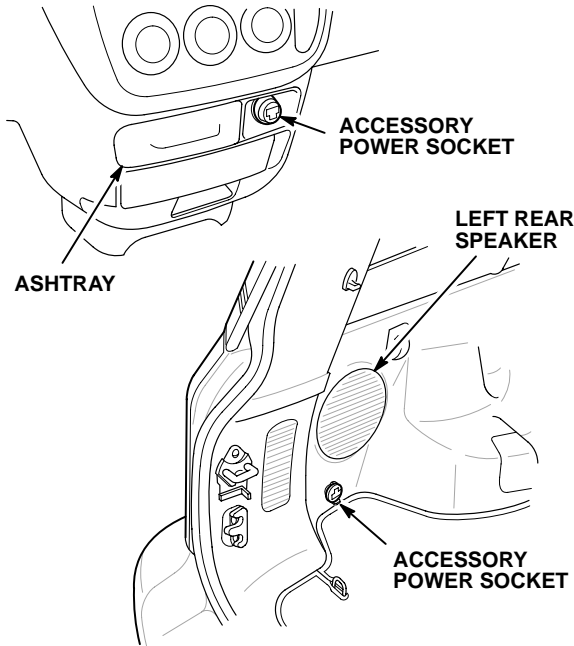

SPARE TIRE COVER SPACER

A spare tire cover spacer is placed in the glovebox at the factory. Insert the spacer in the center of the spare tire before installing the spare tire cover. See Service Bulletin 97-068 for spare tire cover installation instructions.

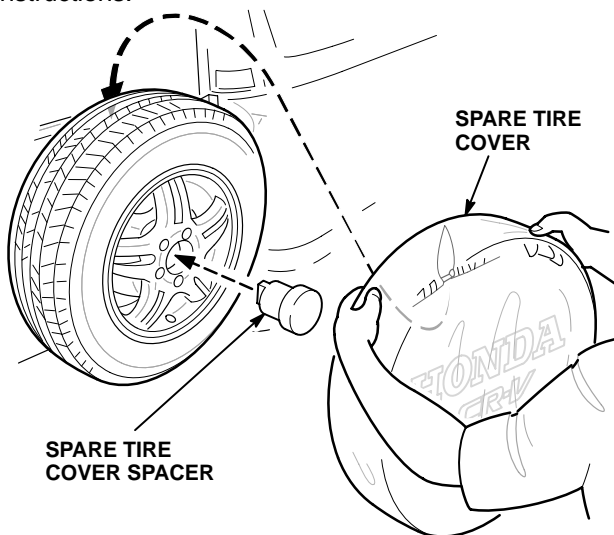

TAILGATE OPERATION

The tailgate is a two-piece construction (hatch glass and tailgate door). The hatch glass can be opened in one of three ways:

1. By using the key in the tailgate lock.
2. By using the hatch release button located on the driver's side lower dashboard, just above the hood release.
3. By pressing the hatch release button (keyless entry) or option button (security system) on the remote, if so equipped.

The tailgate door cannot be opened unless the hatch glass is opened first. When closing the tailgate, the tailgate door must be completely closed before closing the hatch glass. If the hatch glass is closed first, the tailgate door will break the hatch glass when it is closed.

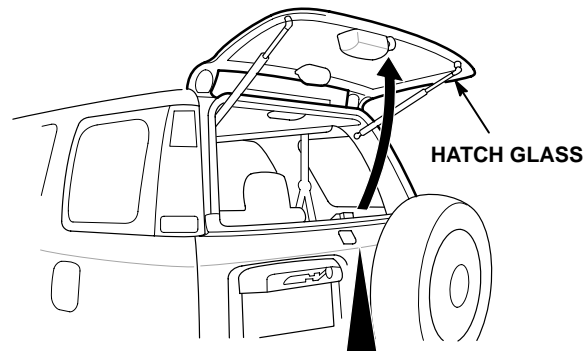

HATCH RELEASE BUTTON

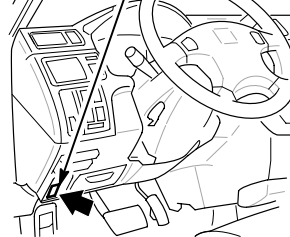

TAILGATE LOCK

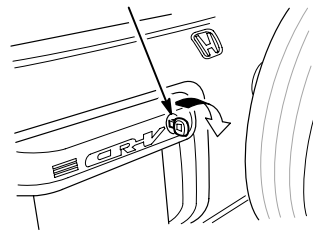

A support strut is used to keep the tailgate door from opening too fast, and to help hold the door open. In strong winds or when parking on a slope, place the stop over the support strut to hold the tailgate door. The stop is packaged with the front license plate holder, and the stop should be stored in the right cargo floor pocket with the tool kit.

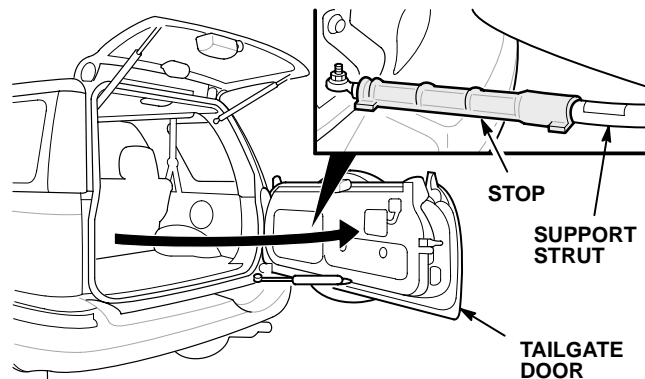

AIR CONDITIONING FILTER

The CR-V air conditioning system comes equipped with an air filter located in the evaporator. The filter is there to keep dust and pollen out of the evaporator core. Refer to the Owner's Manual for the correct filter change schedule.

If the vehicle is used in urban areas that have high concentrations of soot in the air from industry and diesel-powered vehicles, the filter should be replaced more frequently. (Refer to the Owner's Manual for the correct interval.) The filter should be checked anytime that the dash vent airflow appears to be restricted when the system is set on Fresh Air.

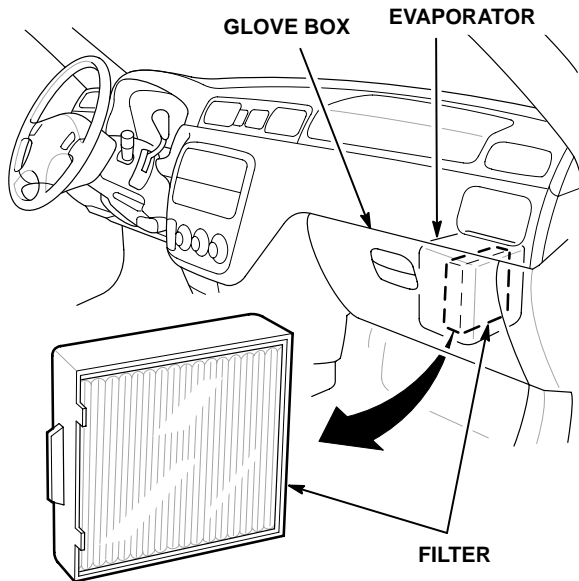

IMMOBILIZER SYSTEM

In some markets, the CR-V comes with an immobilizer system. This system has two major differences from the Prelude system:

- There is no red learning key.
- The starter circuit is not cut, only the fuel supply circuit. So, if an improperly coded key is used, the starter will operate but the engine will not start.

Refer to service bulletin 99-901, *Civic and CR-V Immobilizer System*, for detailed information.